

OTOR

THE LONDON MOTOR SHOW

EARLS COURT 21st-31st OCTOBER 1993

OFFICIAL
Show Guide

£3.00

Level Two

STAND EXHIBITOR

77	Allied Dunbar
228	Ashbrooke Products
230	Astec Communications
192	Auto Express
242	Automobile Association
139	Auto-Q
189	Autronics Security
104	BBC Top Gear Magazine
124	British Racing Green
14	Brooks Auction
81A	BTC Engineering
179	Car Audio Labs
223	Car Stereo & Security
56	Caravan Show
186	CD Heaven
149	Cellnet
29	Chaters Motoring Books
72	Churchill Insurance
3	Cirrus
16	Classic & Sportscars
222	Clifford Electronics
48/142	Colorcote 2000 (IPN)
112A	C&T Eyewear
236	Davenport Marketing
84	David Drills
81B	Devil Performance
208	Devon Clothing
4	Dial Auto Models
240	Digital Security
80	Dimma
32	Direct Line Insurance
40	Drive Wise
183	Dynamco
144	Euro Mul-T-Lock
120	Exchange & Mart
74	Exhaust Factory
26/68	First Choice Products
166	Gamma Electronics
6	Geoff Forty
117	Grand Prix Promotions
28	Haldane Developments
164	Hansard Financial
190	Hawaii Business Show
116	Historic Racing Posters
40	Hometune
64	HPI Autodata
122	Immobiliser
113A	Inchmere Design

92	Jaguar Drivers Club
200	Jarrotts
103	JB Weld Company
238	Kar-Rite Europe
115	Lamborghini Leisure
46	LBC
35	Lomax Motor Co
58	Lynx Motors
114	Marlboro
174	Max Power Magazine
96/128	Mer
214	Milenco
54	Mill Lane Engineering
34	Model Cars Bourne End
156	Motorola Cellular
140	MRK
194	Music Direct
50	National Motor Museum
36	No 1 Tools
52	Overfinch

20	P J Fischer
18	Paradise Garage
146	Pedalock
75/86	Perma Seal
65A	Peter Lewis
65B	Peter Ratcliffe
152	Pioneer Hi-Fi
180	Piranha
160	Pristine Marketing
64C	Providence Capitol

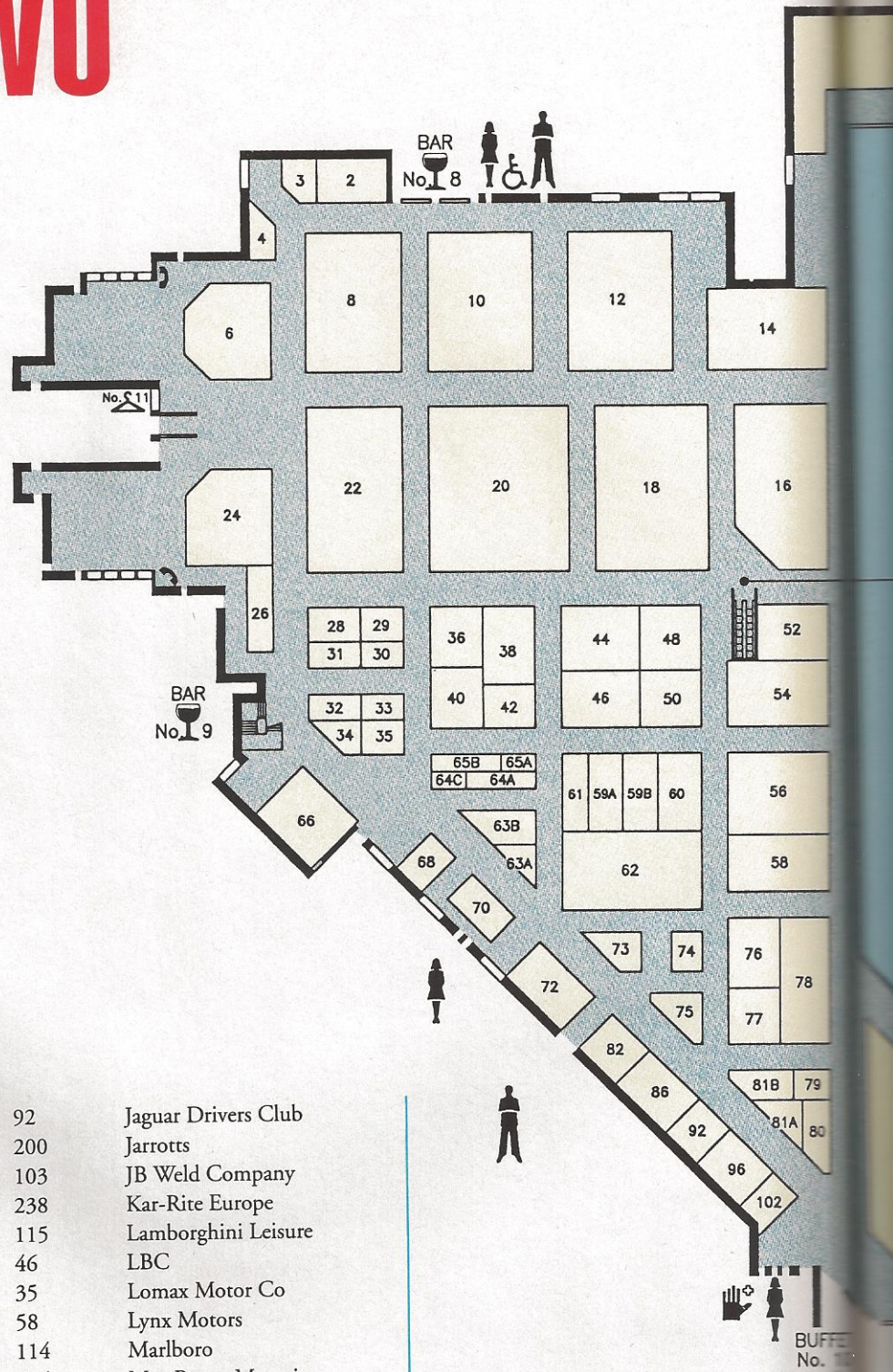

The Scorpio 24V estate car has joined the hatchback and saloon Scorpio models in the range powered by the Cosworth-developed 2.9-litre 24-valve engine, which provides 195bhp and is matched to the latest Ford A4LD four-speed automatic, giving the 24V Scorpio a top speed of almost 140mph



V6 engine is also available in four and five-door Scorpions for 1994, as well as in Scorpio estate and Granada models.

Ford's Dynamic Safety Engineering strategy, already successfully applied to the Escort and Mondeo, now brings improved safety benefits to Granada/Scorpio, including anti-submarining seats, seat belt grabbers and pre-tensioners and a substantially revised bodyshell to give better protection. In addition, all Granada/Scorpio models now have an electronic immobiliser fitted as standard.

The Fiesta range boasts a higher level of safety and security, with a new immobiliser system standard on the sporting XR2i and RS 1800 models.

The Ford commercial vehicle range benefits from safety and security improvements, including a standard driver's-side airbag for Escort, Courier and Fiesta vans, an optional electronic immobiliser for Escort vans, improved door locks and an optional secure load box for the Transit.

FSO Cars Ltd

Unit 3B
Carver Road
Stafford ST16 3HT



☎ : 0785 224490
Fax: 0785 222588 **STAND No J4**

This year sees the reintroduction of FSO Cars from Poland. The new range is based on the diesel engine version of a five-door hatchback and a one-ton diesel pick-up truck. Also available will be a 1.5-litre petrol engine version with a fuel injection system and catalyser.

The diesel power unit is the very popular PSA 1.9L engine manufactured by Citroën of France. This vehicle will be the first 'low cost' family diesel available in the UK. The pick-up truck will have the unique facility of being able to 'drop' three sides to give a flat

loading bed able to take two Europallets side by side.

These new vehicles should not be confused with the FSO products imported throughout the Eighties, as the new engines and vastly improved build quality have considerably enhanced both performance and appearance.



A low-cost family diesel, the new Polish-built FSO Caro 1.9 five-door

GT Developments Ltd

15 Balena Close
Creekmoor Trading Estate
Poole
Dorset BH17 7DB

☎ : 0202 694861
Fax: 0202 604684 **STAND No L12**

See the world premier of the all-new GTD R42 sports car!

GT Developments has been in the business of producing mid-engined sports racing cars for many years.

The GTD R42 is an all-new, mid-engined, British sports car, designed and developed in-house by GT Developments. The power plant is an all-aluminium, quad-cam 32-valve fuel-injected 4.6-litre V8. The chassis is all aluminium and of monocoque construction. The body work can be specified to be constructed in carbon composites or aluminium. Race-bred

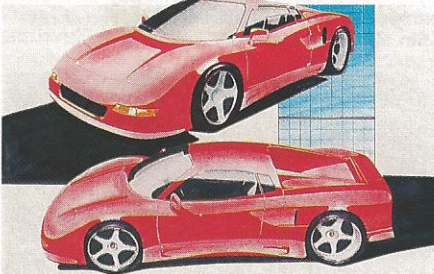

The GTD R42 an exciting all-new mid-engined British sports car

suspension, 5-speed transaxle and race developed brakes give the GTD R42 refinement in equal quantities to performance, giving you, the driver, a true road-going sports-racing car.

The GTD R42 will be in production by Spring 1994. With a maximum output of just 70 cars a year and with orders already

up to 1995, the GTD R42 has quickly established itself as a highly exclusive and very desirable motor car.

The GTD R42 has a top speed of 180mph (depending on engine specified) and 0-60mph in under 5 seconds, making this new car a formidable driving machine.

The GTD R42 is priced from £65,800 including UK taxes. More than half of the production for 1994 is already pre-sold.

Haldane Developments Ltd

11 Hawbank Road
College Milton North
East Kilbride G74 5EG

☎ : 03552 67679
Fax: 03552 67771 **STAND No 28**

Launched at the show, the Haldane HD100 and HD300 sports cars are an exciting fusion of tradition styling and state-of-the-art technology.

Classic lines and authentic chromework are evocative of an era when British sports cars were regarded as the finest in their class.

Beneath the flowing lines of the composite semi-monocoque bodyshell, Ford's 2-litre DOHC with fuel injection, management system, and optional catalytic converter, together with a robust backbone chassis and Geoscan-designed suspension, bestow the car with the smooth power and taut, predictable handling which are the hallmarks of all sports cars.

A comfortable interior, generous boot space and complete range of weather equipment render the Haldane a thoroughly practical car for both daily use and long distance touring.

With VCA Type Approval in place, Haldane sports cars are now in full production and, being priced from £18,000, are targeted on an international market.

Honda UK Ltd

4 Power Road
Chiswick W4 5YT



HONDA

☎ : 081 747 1400
Fax: 081 746 9196 **STAND No M1**

The London Motor Show sees Honda yet again launching another new product onto the UK automotive scene. This year it's the brand new Civic Coupe, a stunning 1.5i-16v model to complete the extensive line-up of three and four-door and CRX Civic variants.

The show will also feature the first